

# Alternator "Big 3" kit



P/N BIG 3

Parts list	
Quantity	Description
5'	Red 1/0 Battery Cable
10'	Black 1/0 Battery Cable
8	Ring Terminal Cable Ends
1	ANL Fuse Holder
1	250 Amp ANL Fuse
4	Red Heat Shrink Tubing
4	Black Heat Shrink Tubing
12	Plastic Cable Ties



**DO NOT RETURN THIS PRODUCT!**

First contact technical support at: **1 (888) MECHMAN**

## Safety first

**Warning: Eye protection must be worn when working on batteries.**

Remove all jewelry before working on the electrical system.

## General

Let the engine cool fully and then remove the negative battery cable with a socket wrench. Reconnect the negative cable(s) last after completing all work.

## Grounding

Think of the current path as a circle. The return path (ground path) must be of the same capability as the positive. Any less capable sections of the ground side of the circle will limit your electrical systems performance.

**Frame/body connections:** Clean all metal surface of any paint or rust with a wire brush or die grinder. Use a conductive corrosion inhibitor available at any electrical parts supply house.

**Uni-body frame warning (grounding):** Many newer vehicles do not have full frames. Because of seams and adhesive attached body components, additional steps may be required. Choose a location on the sub-frame with a double metal wall. If current issues are observed, move ground connections to different frame components.

**GM trucks - 2005 through current applications:** To prevent interference with the factory battery monitoring system, **ONLY** add a ground cable from the battery to the alternator. No body or frame grounds should be added. (See option TWO below)

## Installation option ONE (typical)

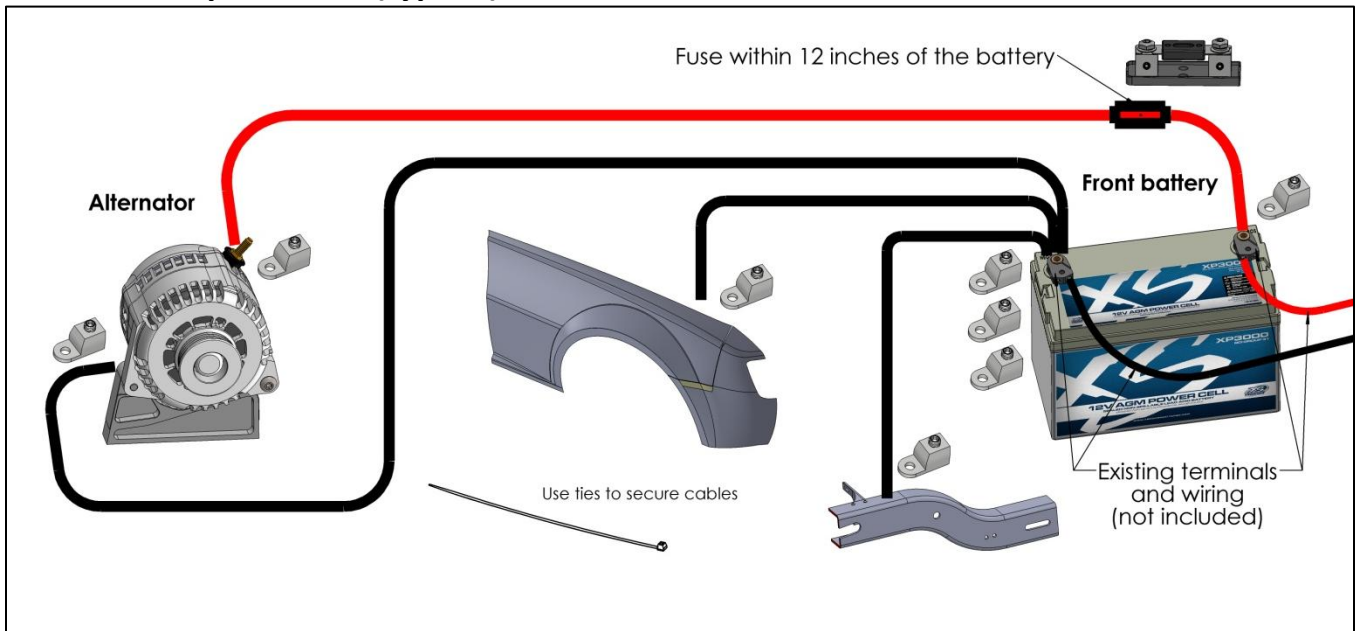

## Installation option TWO (GM Truck - 2005 through current applications)

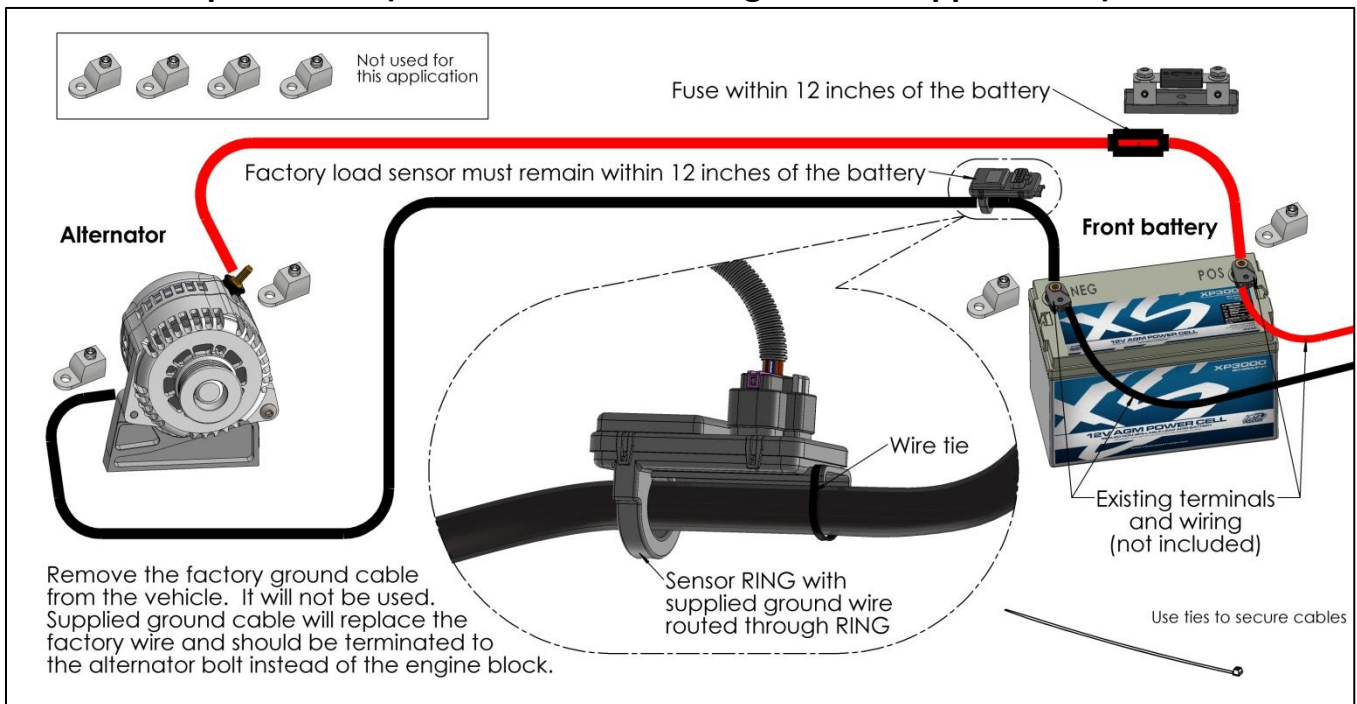

## Wire routing and mounting

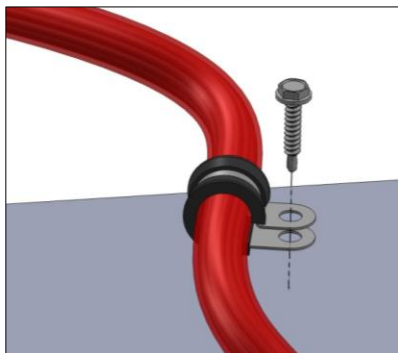

Use screws and insulated mounting clamps (not included) to secure cables to the vehicle.

**Warning:** It is critical that all electrical wiring is kept at least 12" away from heat sources such as exhaust manifolds and other exhaust components. Also avoid moving components such as cooling fans and suspension components.

## Ring terminal assembly (repeat for negative terminals)

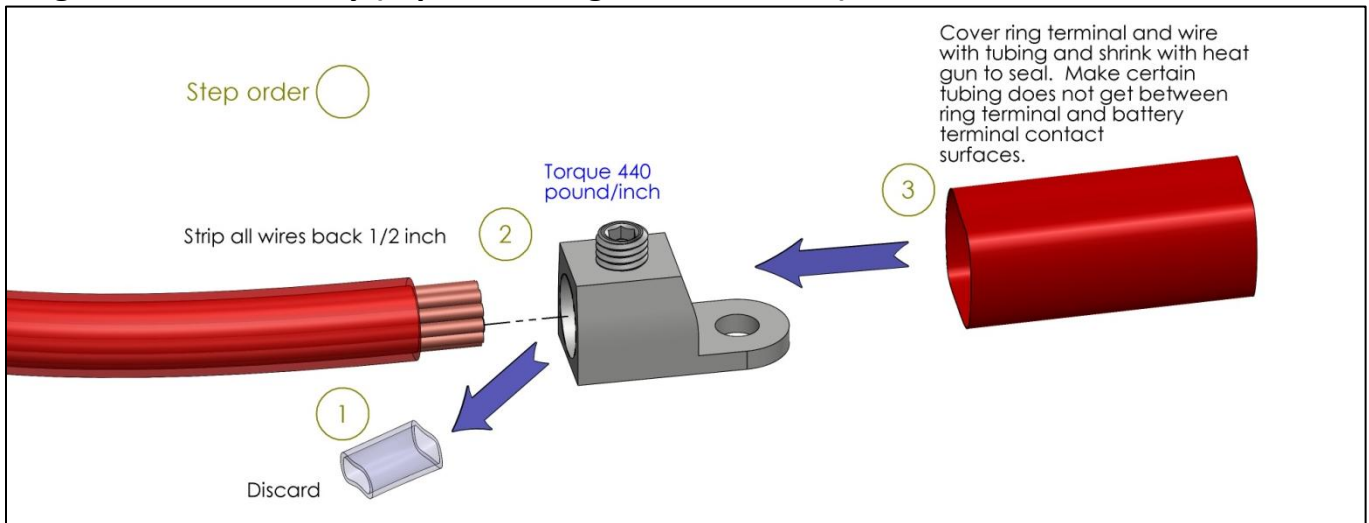

## Fuse holder assembly

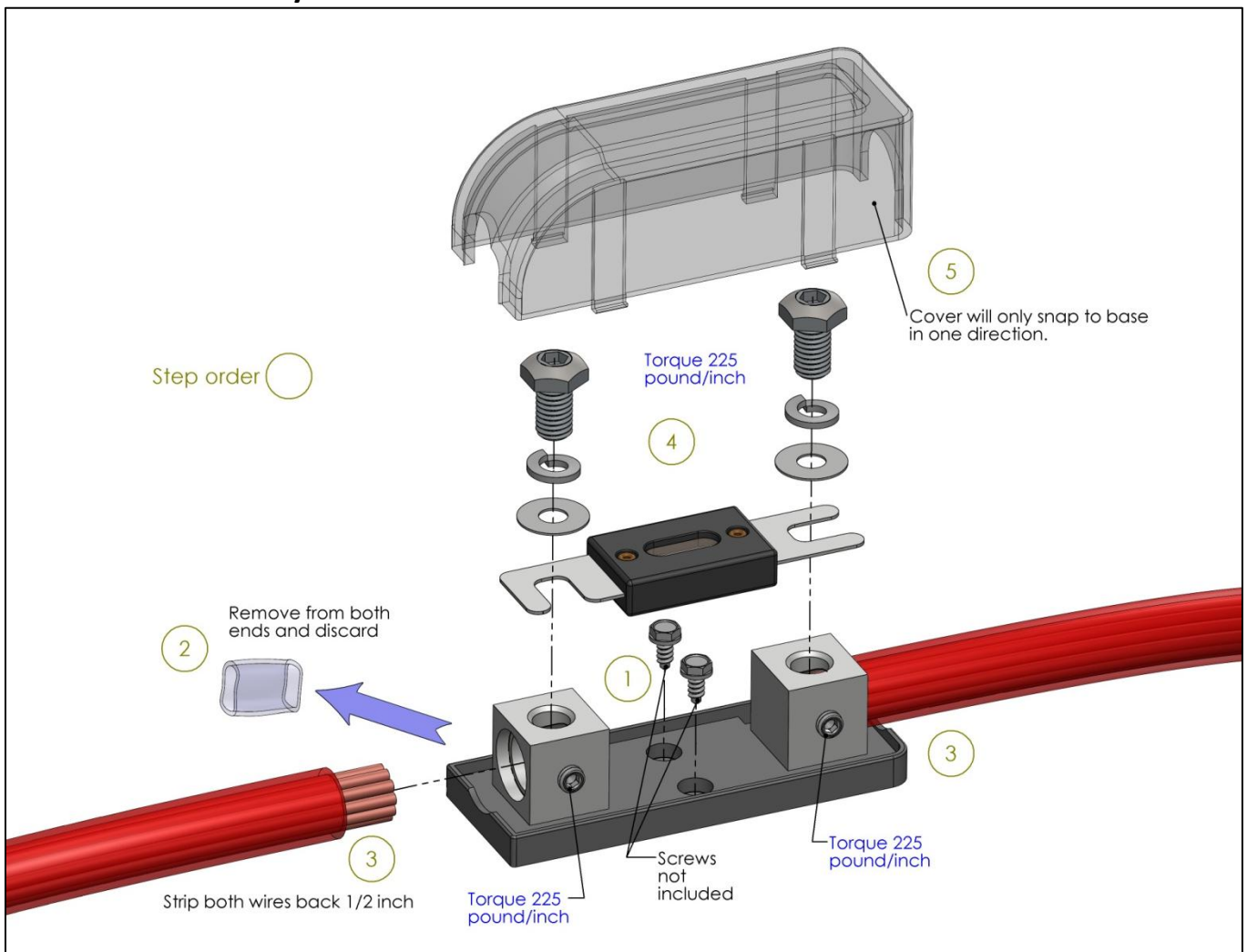

It is recommended a small amount of blue LOCTITE® be used on each ring terminal above screw. Do not get LOCTITE® on electrical connection surfaces because it is nonconductive.